

# SKID HOE OPERATOR'S MANUAL

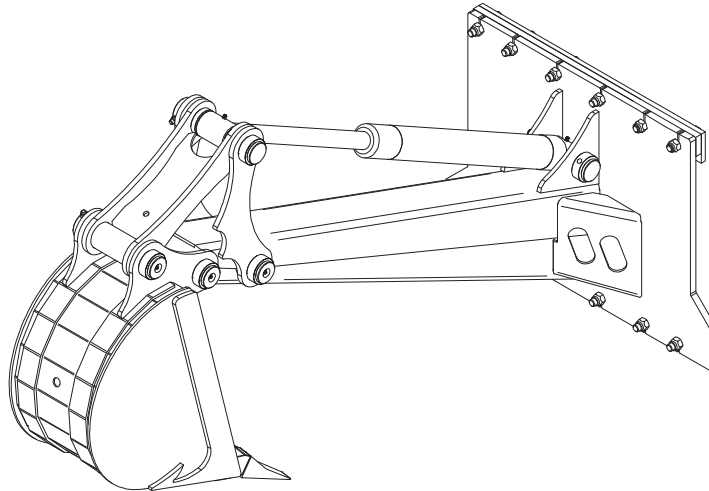

MY.DIGGA.COM



DECAL IS APPLIED TO THE  
ATTACHMENT

MY.DIGGA.COM



DECAL TO BE APPLIED TO  
WINDOW OF MACHINE

**ACCESS OPERATOR MANUALS RISK ASSESSMENTS AND MORE**

# Table of Contents

- Table of Contents . . . . . 3
- To the Purchaser . . . . . 5
- Product Identification . . . . . 6
- Preparation for use . . . . . 9
- Safety Precautions - General Information . . . . . 10
- Safety - Working with the Attachment . . . . . 17
- Safety - Decal Labels . . . . . 21
- Before Use . . . . . 22
- Commissioning Procedure . . . . . 24
- Operating Instructions . . . . . 26
- Maintenance . . . . . 30
- Technical Specifications . . . . . 33
- Spare Parts . . . . . 35
- Troubleshooting . . . . . 37
- Warranty Statement . . . . . 39



## To the Purchaser

Thank you and congratulations on the purchase of your new Digga Skid Hoe.

This product was carefully designed and manufactured to give you years of dependable service. It is mandatory to read these instructions to keep the equipment running in top working condition.

### **Before Operation**

Inspect the attachment for shipping damage and if any damage does exist, do not operate until the damaged parts have been replaced or repaired. The primary responsibility for safety with this equipment falls to the operator. Make sure the equipment is operated only by trained individuals that have read and understood this manual. If there is any portion of this manual or function you do not understand, contact your local authorized Digga dealer or the manufacturer to obtain further assistance. Keep this manual available for reference. Provide the manual to any new owners and/or operators.

### **About This Manual**

This manual has been designed to help you do a better and safer job. **Read this manual carefully and become familiar with its contents before connecting and operating this unit.**

### **Service**

Use only manufacturer replacement parts. Substitute parts may not meet the required standards.



## **CAUTION**

---

**Never allow anyone operate this attachment without reading the “Safety precautions” and “Operating instructions” sections of this manual. Always choose hard and level ground to park the vehicle on and set the brake, so the unit cannot roll.**

# Product Identification

MODELS COVERED IN THIS MANUAL	
SKID HOE	
PART NUMBER	BUCKET WIDTH
BH-000001	300mm (12")
BH-000076	250mm (10")
BH-000077	350mm (14")
BH-000078	400mm (16")
BH-000079	450mm (18")

Your Digga Skid Hoe model provides important information about the product. Compare the model engraved on the serial plate to the list above.

# Product Identification

**Your Digga Skid Hoe is a user non serviceable part.** Unauthorised disassembly will void warranty. When servicing or assembling your product, use only genuine Digga replacement parts. Substitute parts may not meet the standards required for safe and dependable operation. Use of non genuine Digga parts will void warranty and Digga accept no liability what so ever for consequential or special damages. All service must be performed by qualified professionals. Contact your local Digga dealer for details. To facilitate warranty or service, record the model and serial number of your unit in the space provided on this page. This information may be obtained from the identification plate located on the product.

<b>DIGGA</b> www.digga.com	<input type="checkbox"/>	Digga Australia PTY LTD 4 Octal St, Yatala QLD 4207 Australia
Model	<input type="text"/>	
Name	<input type="text"/>	
Serial No.	<input type="text"/>	
Flow (max)	<input type="text"/>	
Pressure (max)	<input type="text"/>	
Power (max)	<input type="text"/>	RPM (max) <input type="text"/>
Approx. Oil Capacity	<input type="checkbox"/>	Y. Mand. <input type="text"/> Weight <input type="text"/>
		DE-000631 MADE IN AUSTRALIA

DE-000631

**Model:** \_\_\_\_\_

**Serial Number:** \_\_\_\_\_

**Purchase Date:** \_\_\_\_\_

## NOTE

The parts department needs this information to ensure accurate parts can be sent to the authorized service agent.

# Notes



## Preparation for use

To avoid any inconvenience before operation, please check that you have received the following items which you may have ordered. Items may differ depending on type of machine the Skid Hoe is to be fitted to.

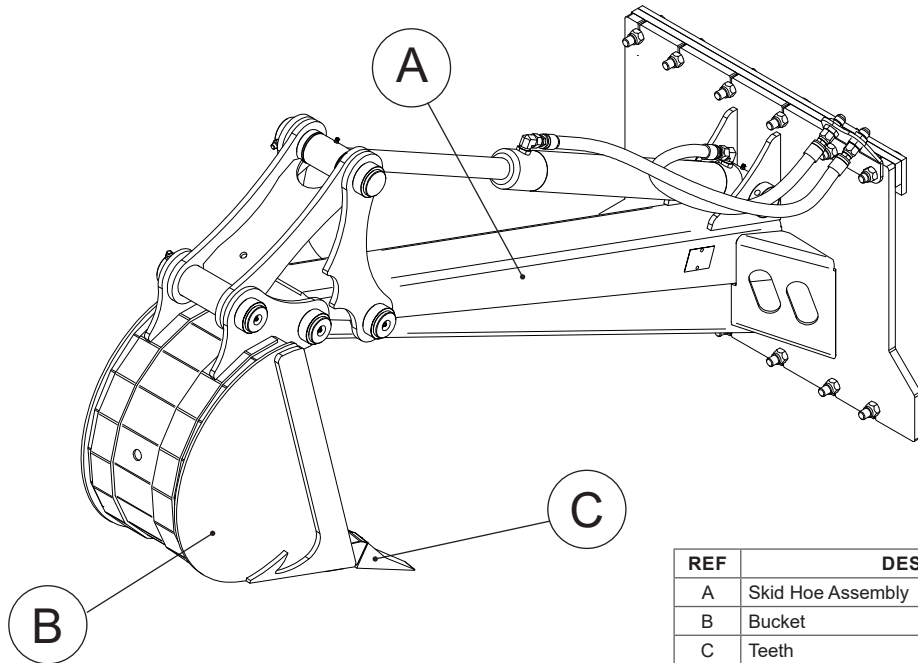

REF	DESCRIPTION	QTY
A	Skid Hoe Assembly	1
B	Bucket	1
C	Teeth	3 or 4

## **Safety Precautions - General Information**

You must understand all safety statements shown on your attachment and in this manual. Especially note the information called out by the designations shown below. Follow these safety precautions, when operating or maintaining the attachment.

### **DANGER**

---

The **DANGER** designation indicates an imminently hazardous situation that, if not avoided, will result in death.

### **WARNING**

---

The **WARNING** designation indicates a potentially hazardous situation that, if not avoided, could result in death or serious injury.

### **CAUTION**

---

The **CAUTION** designation indicates a potentially hazardous situation that, if not avoided, could result in minor or moderate injury or property damage.

## **NOTE**

You will also see information called out with the **NOTE** designation. This additional safety or general information is important to the maintenance and operation of your loader.

During day-to-day operation of your attachment, you will encounter a variety of situations beyond those listed in this manual. We encourage you to assess the risk present at any job site and in every work task before beginning work. Apply appropriate risk mitigation strategies to make safety a first priority at all times, and if these are not sufficient, stop the job and immediately seek the help of a qualified safety consultant.

# Safety Precautions - General Information

## Know where utilities are

- Observe overhead electrical and other utility lines. Be sure the equipment will clear them.
- Before starting any digging project, lodge an enquiry with BYDA (Before you Dig Australia) or your local utilities location service for the identification of buried electrical, telephone, cable wires, gas, water and sewer lines are likely to be present. Unintentionally disrupting these hidden hazards while working with your loader can result in dangerous situations and property damage.
- Only commence works after having received and studied the underground plans and information thoroughly. Never begin work until the work area has been fully marked for underground utilities.
- For more information about digging best practices access [www.byda.com.au](http://www.byda.com.au). Many countries offer a similar service which advises the location of underground services in your area. If available use this service prior to digging, drilling, trenching or any form of excavating and earthmoving.



## **CAUTION**

---

**You must ensure that underground utilities have been officially marked before working in the area. Markings must be valid according to state law or practice.**

## Exposure to Respirable Crystalline Silica Dust Along with Other Hazardous Dusts

- It is recommended to use dust suppression, dust collection, and if necessary personal protective equipment during the operation of this or any other machine attachment that may cause high levels of dust.

## Remove Paint Before Welding or Heating

- Hazardous fumes/dust can be generated when paint is heated by welding, soldering, or using a torch.
- Do all work outside or in a well ventilated area and dispose of paint and solvent properly.

# Safety Precautions - General Information

## Remove paint before welding or heating.

- When sanding or grinding paint, avoid breathing the dust. Wear an approved respirator. If you use solvent or paint stripper, remove stripper with soap and water before welding. Remove solvent or paint stripper containers and other flammable material from area. Allow fumes to disperse at least 15 minutes before welding or heating.

## End of Life Disposal

- At the completion of the useful life of the Skid Hoe, drain all fluids and dismantle by separating the different materials (rubber, steel, plastic, etc.). Follow all federal, state and local regulations for recycling and disposal of the fluid and components.

## Operating the Skid Hoe

- The primary responsibility for safety with this equipment falls to the operator. Make sure that the equipment is operated only by trained individuals, who have read and understood this manual.
- An operator must not use drugs or alcohol, which can change his or her alertness or coordination. An operator taking prescription or over-the-counter drugs should seek medical advice on whether or not he or she can safely operate the equipment.
- Don't hurry the learning process or take the unit for granted.
- It is the skill, care, common sense, and good judgment of the operator that will determine how efficiently and safely the job is performed.
- Visually inspect your equipment, ensure correct assembly and installation is done and never operate the equipment that is not in proper working order.
- Know the capabilities of your equipment and practice its operation to become familiar with the controls, emergency shut down procedures, and the way it handles on your machine.
- Follow all safety decals and keep them clean. Replace them, if they become worn, damaged or illegible.
- Do not paint over, remove or deface any safety signs or warning decals on your equipment.
- Operate only from the operator's station and operate only in daylight or with sufficient artificial light.

## Safety Precautions - General Information

- Always carry loads close to the ground and do not exit the machine with the loader arms raised.
- Do not exceed rated operating capacity (ROC) of the host machine, as machine may become unstable resulting in loss of control. Overloading or exceeding the manufacturers specifications will also void all warranty.

### **WARNING**

**The Skid Hoe boom extends further away from the host machine in comparison to other common machinery attachments. This arrangement might lead to an unstable condition, even if the nominal host machine ROC is not exceeded. The use of counterweights might be required. Refer to the host machine operator's manual for safe operating limits and instructions on the use of counterweights.**

- Always lower the loader arms or the machine boom to the ground, shut off the engine and remove the key before getting off the unit.
- Remove the Skid Hoe from the parent machine before transporting to and from the job site.
- Never use the attachment on a machine that is not equipped with a cab rollover protective structure (ROPS) and/or falling object protective structure (FOPS), and operator restraints (seat belts or equivalent devices). Although, this is not applicable when using this attachment on a stand-on mini loader.
- Establish and maintain a minimum 6 meters (20 feet) exclusion zone around the working area. No person other than the operator should enter the work zone, while the parent machine's engine is running.
- Do not allow site workers to climb on the attachment at any time, including while stationary, in operation or being moved.
- Avoid steep hillside operation which could cause the machine to overturn. Consult your machine operator's and safety manual for maximum allowable incline.
- Reduce speed when driving over rough terrain, on a slope or turning to avoid overturning the machine.
- Travel only with the Skid Hoe in a safe transport position to prevent the uncontrolled movement.
- Drive slowly over rough ground and on slopes.

## Safety Precautions - General Information

- Tether any accessory connected to the Skid Hoe with a chain if necessary, to prevent uncontrolled swinging of the attachments.
- Do not drive close to ditches and excavations, etc, as cave in could result.
- Flow and pressure gauges, fittings, and hoses must have a continuous operating pressure rating of at least 25% higher than the highest pressure of the system.
- All operations must be stopped in the event of local thunderstorm or lightning activity. During operation, weather conditions shall be monitored, operations shall cease during electrical storms or when electrical storms are imminent. Ground personnel and bystanders.
- Be alert to others in the work area. Be sure others know when and where you will be working.
- Loose fitting clothing, long hair, jewellery and equipment which might become entangled in moving equipment are prohibited while working near the Skid Hoe .
- Operators, helpers, and other personnel working near the attachment must wear steel-toe safety shoes, safety glasses, and hard hats as a minimum. Hearing protection, respirators, and personal protective clothing will be specified in the site-specific Health and Safety Plan.
- The Skid Hoe shall be cleaned only when the mechanism is in neutral and stopped; long-handled shovels shall be used to move debris from the Skid Hoe. Materials heavier than 10 kg must be moved mechanically or by using at least two people.
- The Skid Hoe shall be used only for their designed intent and shall not be loaded beyond their rated capacity. Overloading or exceeding the manufacturers specifications will void all warranty.



### **CAUTION**

---

**Wait for the mechanism to completely stop before making any adjustments or cleaning.**

# Safety Precautions - General Information

## DANGER

During Skid Hoe operation, maintain a minimum “no-work zone” buffer of 10 feet (3 meters) from any overhead electrical service and 6 feet (2 meters) from any underground service . All bystanders should be kept at a minimum of 20 feet (6 meters) away from the working area of the Skid Hoe.

### Storing your Skid Hoe

- Seal hydraulic couplers from contaminants and secure all hydraulic hoses off the ground to help prevent damage.
- Clean the unit thoroughly by removing all mud, dirt, grease, etc..
- Inspect for visible signs of wear, breakage, or damage. If required, order any damage parts and perform the necessary repairs to avoid delays upon removal from storage.
- Check that hydraulic cylinder and hoses are full of clean oil and apply grease to all grease nipple points.
- Coat liberally with grease all connecting pins and exposed parts of hydraulic cylinders' rods to prevent rust and reduce wear.
- Tighten loose nuts, cap screws, and hydraulic connections.
- Replace safety decals that are damaged or in an unreadable condition.
- Store unit in a dry and protected place, as leaving the unit outside will materially shorten its life.

### Maintaining the Skid Hoe

- All maintenance should be performed with the engine turned off, parking brakes applied, machine arms lowered, and hydraulic pressure relieved.
- Lock out and tag out the equipment before repairs or maintenance is performed.
- Only properly trained and qualified individuals are permitted to perform repairs and maintenance.
- If lift arms must be left raised for any reason, use a positive lift arm lock to secure the arms in place. Serious damage or personal injury could result from lift arms accidentally lowering.

## Safety Precautions - General Information

- Never adjust a relief valve for pressure higher than recommended by the machine's manufacturer.

### Transporting the Skid Hoe

- When transporting your attachment, follow all local government regulations that may apply along with any equipment safety precautions provided in this manual.
- It is the responsibility of the operator that safe systems of work are employed while handling this attachment.
- No tie down points are provided on the attachment and its the responsibility of the operator to ensure that the attachment is firmly fastened without causing any damage to it.
- Do not attach tie down accessories around cylinders or in any way that may damage hoses or hydraulic components.
- Attachment should be well secured, when being moved or in transit and furthermore prior to moving, storing, loading/unloading,or parking.
- Verify that all tie down accessories (chains, slings, ropes, shackles, etc.) are capable of maintaining attachment stability during transporting and are attached in such a way to prevent unintended engagement or shifting of the unit.
- Use extra care when loading or unloading the attachment on to a trailer or truck and disconnect hydraulic couplers during the transportation. No responsibility for loss or damage to persons or property in any regard can be attributed to Digga.



# Safety - Working with the Attachment

## Complete a Risk Assessment

Your Digga Skid Hoe is a versatile machinery attachment, capable of performing its tasks in a safe and effective manner. To ensure the safety of operators and others, it is important to document the work at hand for hazard and risk. Before beginning work, complete a risk assessment. The following steps provide a framework for this activity:

1	<b>DOCUMENT THE ACTIVITY</b> Assemble those involved in the activity. Write down the tasks required for the activity in step-by-step form.
2	<b>IDENTIFY THE HAZARDS</b> Next to each task, identify what part of the task may cause injury to those engaged in the task or others in the vicinity. Rate the consequences and likelihood of the hazard using the risk assessment matrix.
3	<b>DOCUMENT THE CONTROL MEASURES</b> Using the results from the risk assessment matrix, determine which hazards require attention. List all mitigation measures that are required to eliminate or minimize those hazards.
4	<b>IDENTIFY THE RESPONSIBLE PERSON</b> Document the name of the person responsible for implementation of the mitigation measure.
5	<b>MONITOR AND REVIEW</b> Ensure that the activity is supervised and that the documented process is being followed.

## NOTE

Remember, Personal Protection Equipment (PPE) provides a level of protection during work, but PPE is the last level of hazard control and prevention. Always refer to the hierarchy of hazard control, when planning a safety process.

## Safety - Working with the Attachment

**Take Extreme Care When Dealing with Hydraulics - Whilst Assembling, Operating, Maintaining or Performing any work on or near this product.**

- Hydraulic fluid under pressure can penetrate the skin and may develop gangrene or other permanent disabilities. **Hydraulic leaks under pressure may not be visible!**
- If any fluid penetrates the skin, **get immediate medical attention!**
- Wear safety glasses, protective clothing, and use a sound piece of cardboard or wood when searching for hydraulic leaks. **Do not use your hands!**
- Before connecting or disconnecting hydraulic hoses, read your machine or power unit's operator manual for detailed instructions on connecting and disconnecting hydraulic attachments.
- Ensure that all parts meet the specifications for this product when installing or replacing hydraulic hoses or fittings.
- After connecting hydraulic lines:
  - Slowly and carefully raise the loader's arm(s) and cycle the rollback/dump cylinders to check hose clearances and to check for any interference.
  - Operate the hydraulics on this product to ascertain forward and reverse.
  - Ensure that the hoses cannot interfere with or actuate the quick-attach mechanism.
  - Ensure that hoses will not be pinched, or get tangled, in any equipment.
- Do not lock the auxiliary hydraulics in the "ON" position.
- Refer to host machine operator's manual and this manual for procedures and service intervals, then inspect and maintain the entire hydraulic system to ensure that the fluid remains clean, that all devices function properly, and that there are no fluid leaks.

### **NOTE**

**For any additional safety information please see "Risk Management Booklet". To obtain a copy of this document please contact Digga Head Office.**

# Safety - Working with the Attachment

## When Mounting this Product to Your Machine

- Refer to the operator's manual of your host machine for any special or detailed mounting instructions regarding the quick-attach mechanism.
- This product should fit onto the quick-attach frame or hitch (machine mount). If this product does not fit properly, contact your Digga dealer before operating.
- Where enabler 'Dead Man' controls are installed it is illegal to disengage, tamper with, or remove them.



## **WARNING**

---

Never place any part of your body into the mounting plate, frame, hitch or loader holes. A slight movement of the power unit and this product could cause serious injury.

## When Adjusting Servicing or Repairing this Product

- Do not make any modifications to your Digga attachment.
- When making repairs use only authorized Digga service agents and use only genuine Digga parts. For fasteners, hydraulic hoses, or hydraulic fittings, use only properly rated parts.
- Replacement parts must also have safety signs attached.







## **CAUTION**

---



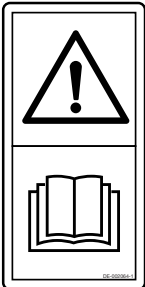
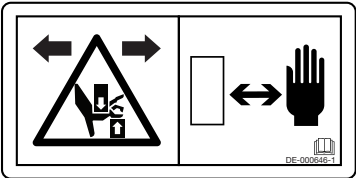

Wait for all moving parts to stop completely before making any adjustments or cleaning.

## Safety - Decal Labels

This section provides a glossary of safety labels found on your Digga Skid Hoe. These labels are important! Become familiar with both their meaning and location prior to operating the Skid Hoe. Ensure that each label is clean, visible, and legible at all times. To clean the decal, use a soft cloth, water, and soap. Avoid the use of solvents, gasoline, or other harsh chemicals, as these may damage the decal. If a label has been damaged or removed, it must be replaced.

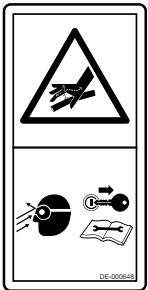
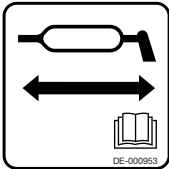
READ OPERATOR'S MANUAL	PINCH POINT HAZARD	ENTANGLEMENT / CRUSH HAZARD
		
<p><b> DANGER</b></p> <p>Completely read and understand this operator's manual before using your attachment. Keep the manual with the attachment at all times.</p>	<p><b> DANGER</b></p> <p>Keep hands away from moving parts.</p>	<p><b> DANGER</b></p> <p>Keep hands and body parts clear of the attachment. Keep all bystanders at a safe distance (6 meters/20 feet) from operating attachment and work zone.</p>

# Safety - Decal Labels

FLUID UNDER PRESSURE	GREASE POINTS	MY.DIGGA.COM
		
<p><b> WARNING</b></p> <p>Refer to page 25 about fluid injection hazard. Wear eye protection. Before performing any maintenance on the attachment, switch the hosting machine engine off and remove the key. Never leave the key in an unattended machine.</p>	<p><b> CAUTION</b></p> <p>Lubricate the pivots using the grease points frequently. Refer to "Greasing" on page 34.</p>	<p><b>NOTE</b></p> <p>Scan the QR-code to access my.digga.com and find manuals, safety information, guides and more.</p>

# Safety - Decal Labels

ITEM	ORDER CODE	DESCRIPTION	QTY
1	DE-000631	Serial Tag	1
2	DE-000649	Entanglement / Crush Hazard	2
3	DE-002064-1	Read Operator's Manual	1
4	DE-000648	Fluid Under Pressure	1
5	DE-000646-1	Pinch/Crush Point - Keep Hands Off	2
6	DE-000953	Grease Points	2
7	DE-000049	Digga Logo	2
8	DE-000850	my.digga.com	1
9	DE-000046	Before You Dig (AUS only)	1

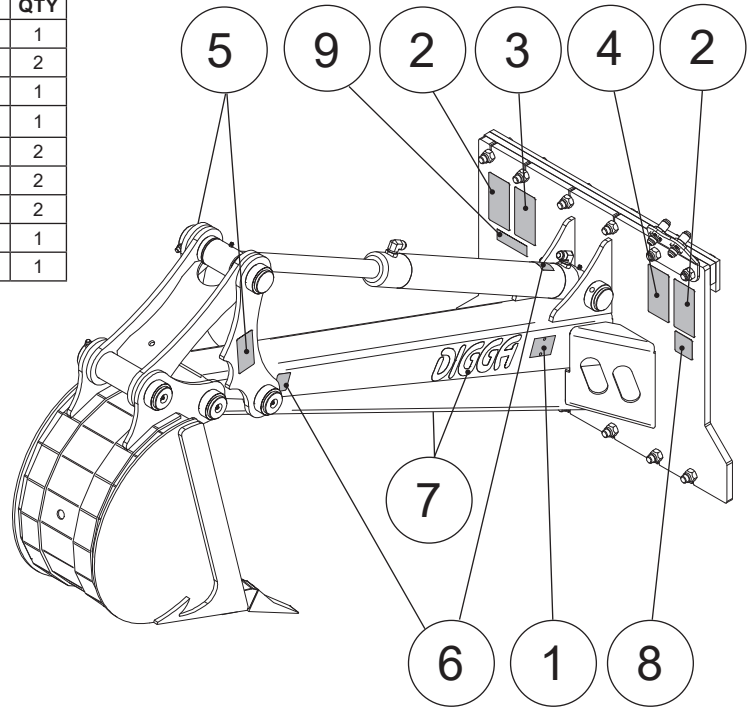
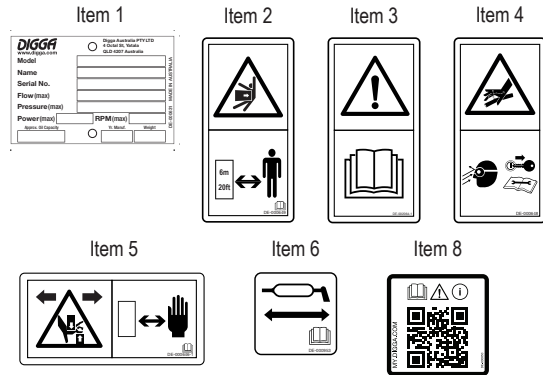

## Before Use

The key feature of your Skid Hoe is low maintenance, requiring only regular lubrication. It does not contain user-serviceable parts, and any unauthorised disassembly will void the warranty. Before performing any disassembly, written permission from Digga must be obtained.



## DANGER

---

**Safety first!! Read and understand the safety instructions before beginning any maintenance.**

### Before First Use

Inspect the Skid Hoe for shipping damage. If damage does exist, do not operate until the damaged parts have been replaced or repaired.

### Before Each Use

- Make sure that all nuts and bolts are in place and properly tightened.
- Make sure that all other fasteners are in place and are performing their specified function.
- Make sure that all hydraulic fittings are tightened and that there are no leaks in any fittings or hoses.
- Make sure that all safety signs are in place, are clean, and are legible (see "Safety - Decal Labels" on page 21)
- Check for wear and tear on pins, linkages, cutting edges and replace any damaged parts and excessively worn parts.
- Use only manufacturer recommended replacement parts. Other parts may be substandard in fit and quality.
- Ensure any damage or excessively worn parts are replaced.
- Always wear safety goggles or glasses when inspecting equipment.
- Grease all (5) lubrication points. See "Greasing" on page 34.



**!** WARNING

Escaping fluid under pressure as low as 100 PSI can have sufficient force to penetrate the skin up to 4" (100mm) away causing serious personal injury. Fluid escaping from a very small hole can be almost invisible. Use a piece of cardboard or wood, rather than hands to search for suspected leaks (A). Keep unprotected body parts, such as face, eyes, and arms as far away as possible from a suspected leak and use heavy duty PVC protective gloves. Flesh injected with hydraulic fluid may develop gangrene or other permanent disabilities.

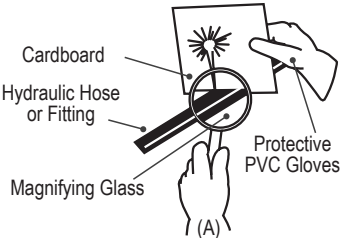

**!** WARNING

Always wear the correct PPE, when operating or performing maintenance on this attachment. If a hydraulic fluid injection injury occurs, seek emergency medical attention immediately. Explain to medical staff that the injury is the result of pressurised fluid injection. Remember that even if the point of entry appears as a minor pin hole, this potentially could be a major injury, especially if not treated in time.

# Commissioning Procedure

The Digga Skid Hoe attaches to the tool bar/quick-attach mechanism of your Machine. Due to this arrangement, thorough knowledge of the machinery controls is necessary for machine operation. Read and understand your machine operator's manual for information regarding machine operation before attempting to use the Skid Hoe. When a Skid Hoe is purchased from DIGGA or a DIGGA Dealer/Distributor, the frame/attachment is matched for suitability and compatibility to the flow, pressures and load ratings of the original machine it was purchased for. For fitment of the Skid Hoe to other machines you must first contact your DIGGA dealer and receive written confirmation to ensure you do not incorrectly fit the attachment to a machine with higher pressure, or lower rated load capacities than what the product was designed for.

Warranty will be void if the Skid Hoe is fitted to an alternative machine without first receiving written confirmation from your DIGGA dealer. Exceeding the recommended maximum flow, pressure, or rated load capacity of the Skid Hoe as stated on the serial tag will void all warranty.

Check the work site and identify the extent of the work to be carried out and note any possible hazards or constraints. Overhead cables, underground utilities, services, etc. Check with relevant service providers on the location of these before commencement of any work (see "Know where utilities are" on page 11). Review the job at hand and determine the Skid Hoe is appropriate for the intended conditions. For example: Do not use it as a lifting device.

## Operating Parameters

Ensure your machines flow and pressures do not exceed the maximum rated flow and pressures of the Skid Hoe. Maximum flow and pressure ratings are stated on your Skid Hoe serial tag (see "Product Identification" on page 6). It is the responsibility of the operator to ensure the unit's maximum rated flow and pressure are never exceeded. Make sure the host machine has a port relief installed on its hydraulic tilt circuit.

The Digga Skid Hoe receives its power from the host machine through the auxiliary valve circuit with Quick Release Couplers normally located on the machine arms near the front. Attaching points on the Skid Hoe are the same as the bucket attaching points on your machine.

# Commissioning Procedure

## **NOTE**

Never exceed the maximum flow and pressure ratings as warranty will be void. If you are in any doubt contact your Digga Dealer for assistance.

## **Installation instructions**

1. Remove the shipping banding from around the Skid Hoe and frame.
2. Remove any attachments from the front of the Machine.
3. Ensure you have read the serial tag on the Skid Hoe to obtain the maximum flow and pressure ratings. Ensure your machine flow and pressure settings are aligned with the requirements of the Skid Hoe.
4. Following all standard safety practices and the instructions for installing an attachment in your machine and quick-attach operator's manuals, install the Skid Hoe onto your Machine

## **NOTE**

It is important to make sure the locking mechanism on your quick attach is engaged, therefore locking the attachment onto the machine.

5. Lower the unit to the ground and remove the key from the parent machine.
6. Relieve any pressure from the auxiliary hydraulic system and after making sure that there is not any foreign matter on the hydraulic couplers, connect the power supply and return couplers to the auxiliary hydraulic system of your machine.
7. Route the hoses in such a fashion as to avoid pinching or chafing.
8. Carefully raise the machine arms and cycle the tilt cylinders to check clearances and to verify that all mounting procedures have been successfully completed.
9. Verify hose clearances and check for any interference. Your attachment is now ready for use.

# Operating Instructions



## **DANGER**

---

**Safety first!! Read and understand the safety instructions before operating the attachment.**



## **WARNING**

---

**Use caution when raising loaded bucket. Objects could fall from bucket toward bystanders or operator.**



## **WARNING**

---

**Never lift this product above the operator's eye level or to a height where visibility is obstructed, which ever is lower.**

### **Digging**

1. Be sure the loader is on solid ground before digging or lifting any load.
2. With the loader arms partially raised and the bucket cylinder partially extended, slowly curl the dipperstick toward the loader (using the loader's tilt control). The loader arms may need to be lowered or raised and/or the bucket cylinder extended to allow the bucket to penetrate the soil.
3. As the bucket fills, extend the bucket cylinder and extend the dipper or raise the loader arms to lift the bucket clear of the hole.
4. The depth of the hole will be controlled by the amount the dipper is extended and the height of the loader arms.
  - Use extreme care when working on hillsides. Always dump loaded bucket on uphill side of Skid Hoe to minimize possibility of upset.
  - Exercise caution when working close to fences, ditches, or on uneven ground.
  - Do not dig close to the loader's wheels or under the loader; this could cause a cave-in and vehicle over-turn.

## Dumping on ground

With the bucket raised clear of the hole, slowly back up and pivot the loader rearward about the front wheels. This will swing the loader away from the trench, and the bucket to the side to dump.

Keep loads close to the ground while transporting.

## Cutting a shallow trench

With the loader arms partially raised and the bucket cylinder partially extended, slowly curl the dipperstick toward the loader (using the loader's tilt control). The loader arms may need to be lowered or raised to allow the bucket to penetrate the soil.

When the bucket is positioned at the desired depth, slowly back up the loader, keeping the bucket height constant to cut a shallow amount of soil.

## NOTE

The tilt circuit of your power unit must be protected with a port relief; ignoring this precaution can result in damage to your power unit and/or this product and will void your Digga warranty.

## Filling a trench

1. With the loader arms partially raised, curl the dipperstick (attachment mainframe) forward with the bucket cylinder extended and the bottom of the bucket flat on the ground. The entire height of the bucket should be visible.
2. Use the loader's tilt cylinder only to raise the bucket above the material pile.
3. Pivot the loader to reach over the pile and tilt the Skid Hoe downward so the bottom of the bucket is approximately 300mm (12") below the top of the pile.
4. Pivot the loader toward the trench, using the side of the bucket to move the material into the trench. Repeat this process, lowering the bucket 150mm (6") at a time.

## Operating Instructions

5. Move your power unit forward and repeat the above steps to continue filling the trench.
  - Always lower the bucket to the ground, set the parking brake, stop engine, remove ignition key and wait for all moving parts to stop before leaving the operator's seat.

### **NOTE**

**Make sure the portion of the trench to be driven on is full before moving forward. Moving on an unstable surface can result in damage to your Loader and/or this product and will void your Digga warranty.**

# Operating Instructions

## Slide frame

The slide frame allows the Skid Hoe to reach closer to walls and other obstacles. To slide the frame, loosen the 12 x 5/8" Hex Bolts located at the back of the Skid Hoe sliding plate. While wearing safety boots, use your foot on the wider part of the boom to push the Skid Hoe alongside the slide frame. Once in position, re-tighten the bolts.

## **NOTE**

Avoid overpassing the slide frame, which could leave the attachment hanging on the side. Preferably, use the attachment in the centre of the frame.

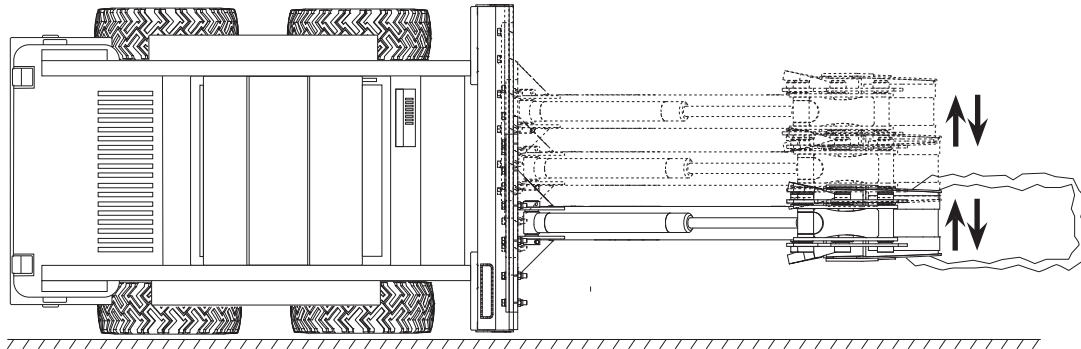
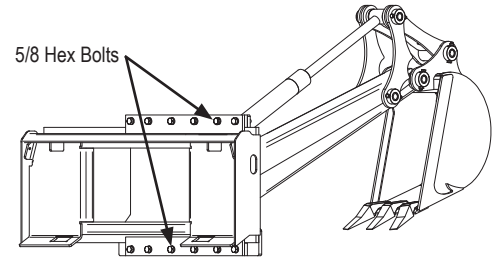

# Maintenance

## Replacing Bucket

To accommodate different jobs, the bucket can be replaced with a narrower or wider one as needed. Before proceeding with the bucket replacement, follow all safety precautions (see "Safety Precautions - General Information" on page 10).

1. Lower the bucket onto level and firm ground.
2. Turn off the host machine and secure its arms in place.
3. Avoid relying solely on hydraulic pressure to secure the machine's arm and attachment.
4. Use wedges to prevent the bucket from tilting.
5. Remove the bolts from the 2 bucket pins.
6. Knock the 2 bucket pins out of their housings.
7. Lift the arm to release the bucket.
8. Follow the reverse procedure to install the other bucket.
9. Apply grease to the bucket pins using their grease nipples.

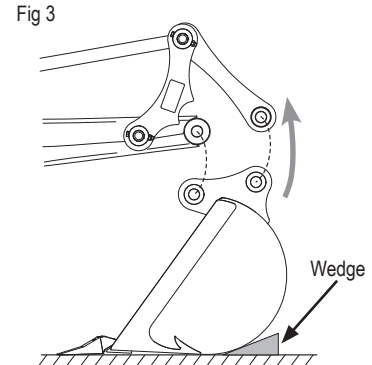
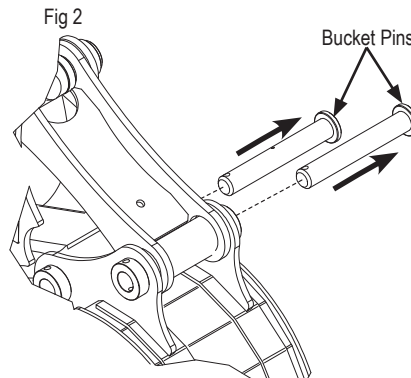
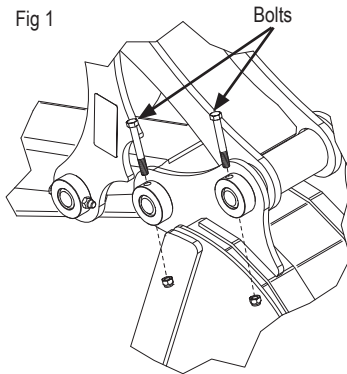



## Replacing Teeth

The Skid Hoe bucket comes equipped with All-Purpose Chisel Teeth as standard. For other tooth options, consult your Digga Dealer. To replace worn teeth or change the bucket configuration, follow these steps:

1. Knock the tooth roll pin through using a punch or similar tool, as shown in Fig 1.
2. Knock the tooth to loosen it from the shank and remove it (Fig 2). Clean the shank if required.
3. Fit the new tooth to the shank and knock a new roll pin using a hammer (Fig 3). If required, use a punch to insert the roll pin fully in.

Fig 1

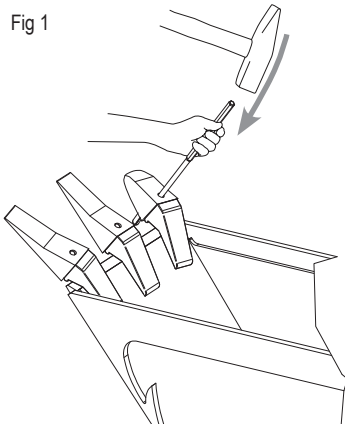

Fig 2

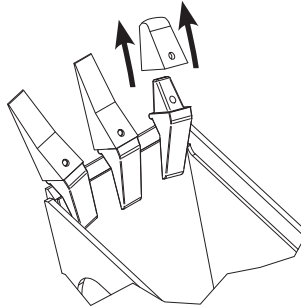
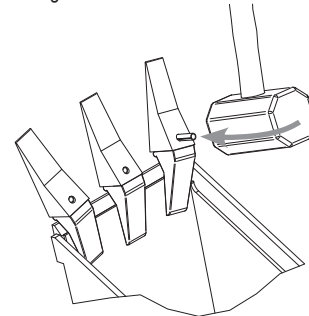

Fig 3



## **NOTE**

Using worn teeth reduces the performance of the attachment and might damage the shanks.

# Maintenance

## Greasing

The Skid Hoe has 5 lubrication points that require greasing every 8 working hours, or more frequently based on operational conditions. The grease nipple locations are indicated below:

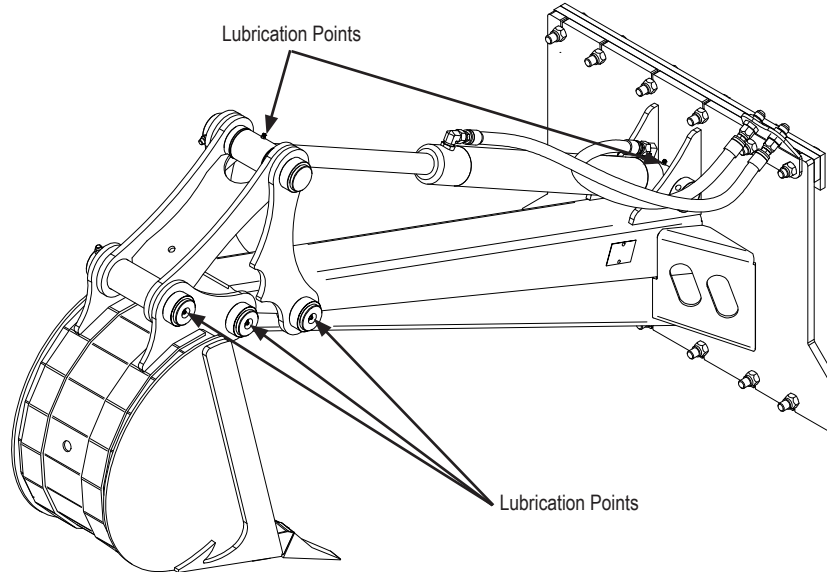

## Main dimensions

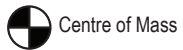
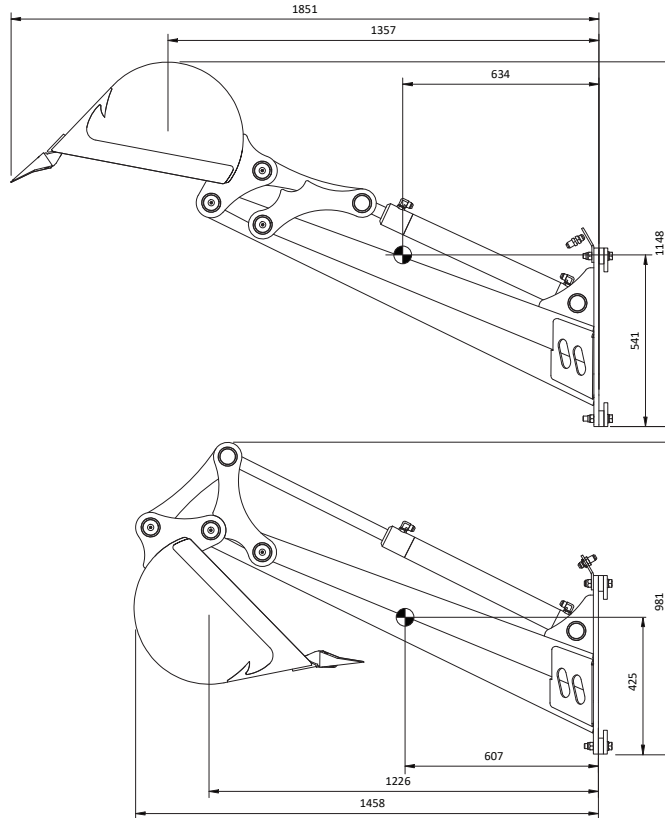

# Technical Specifications

DESCRIPTION	SKID HOE
REACH	1890mm (74.4")
WIDTH	660mm (26")
DIGGING DEPTH	1700mm (67")
WEIGHT (WITH 12" WIDE BUCKET)	185 kg (408 lbs)

DESCRIPTION	10" WIDE BUCKET	12" WIDE BUCKET	14" WIDE BUCKET	16" WIDE BUCKET	18" WIDE BUCKET
WIDTH	252.5 mm (9.9 ")	302.5 mm (11.9 ")	352.5 mm (13.9 ")	402.5 mm (15.8 ")	452.5 mm (17.8 ")
STRUCK VOLUME	0.037 m <sup>3</sup> (1.29 ft <sup>3</sup> )	0.044 m <sup>3</sup> (1.55 ft <sup>3</sup> )	0.051 m <sup>3</sup> (1.81 ft <sup>3</sup> )	0.058 m <sup>3</sup> (2.06 ft <sup>3</sup> )	0.066 m <sup>3</sup> (2.32 ft <sup>3</sup> )
HEAPED VOLUME	0.043 m <sup>3</sup> (1.51 ft <sup>3</sup> )	0.053 m <sup>3</sup> (1.85 ft <sup>3</sup> )	0.062 m <sup>3</sup> (2.21 ft <sup>3</sup> )	0.073 m <sup>3</sup> (2.56 ft <sup>3</sup> )	0.083 m <sup>3</sup> (2.92 ft <sup>3</sup> )
WEIGHT (EMPTY)	37kg (81 lbs)	43 kg (94 lbs)	45 kg (100 lbs)	48 kg (105 lbs)	51 kg (112 lbs)
TEETH	3	3	3	3	4

# Spare Parts

For spare parts of your Skid Hoe, obtain the serial number from the aluminium serial tag located on the side of the boom of the Skid Hoe. The serial number allows Digga to trace all production and service records. Ensure all service and maintenance is performed by an authorized Digga service agent and all service records are kept. Below is a list of common replacement parts for your Skid Hoe. For all other spare parts contact your nearest Digga dealer or Digga Head Office.

DESCRIPTION	QTY	PART NUMBER
SKID HOE - BUCKET - 250mm (10") WIDE	1	BH-000052
SKID HOE - BUCKET - 300mm (12") WIDE	1	BH-000003
SKID HOE - BUCKET - 350mm (14") WIDE	1	BH-000057
SKID HOE - BUCKET - 400mm (16") WIDE	1	BH-000061
SKID HOE - BUCKET - 450mm (18") WIDE	1	BH-000065
CHISEL TOOTH	3 or 4	WP-000179

# Spare Parts

For further information on spare parts, please contact one of the Digga sales offices shown below, or contact your local authorised Digga dealer.

## DIGGA INTERNATIONAL SALES OFFICES

### ASIA PACIFIC

#### DIGGA HEAD OFFICE - BRISBANE

4 Octal St, Yatala QLD 4207  
Phone: +61 7 3807 3330  
Email: [info@digga.com](mailto:info@digga.com)

#### DIGGA NEW SOUTH WALES

19 McKay Close,  
Wetherill Park, NSW 2164  
Phone: 1300 2 DIGGA  
Email: [nsw@digga.com](mailto:nsw@digga.com)

#### DIGGA VICTORIA

17-21 Babbage Dr,  
Dandenong, VIC 3175  
Phone: 1300 2 DIGGA  
Email: [vic@digga.com](mailto:vic@digga.com)

Web: [www.digga.com](http://www.digga.com)

### NORTH AMERICA

#### DIGGA NORTH AMERICA

2325 Industrial Parkway SW  
Dyersville IA 52040  
Phone: + 1 563 875 7915  
Email: [infous@digga.com](mailto:infous@digga.com)

Web: [www.diggausa.com](http://www.diggausa.com)

### EUROPE

#### DIGGA EUROPE

Unit 6, Smitham Bridge Road  
Hungerford Trading Estate,  
Hungerford, Berkshire RG17 0QU  
England, United Kingdom  
Phone: +44 (0) 1488 688 550  
Email: [infouk@digga.com](mailto:infouk@digga.com)

Web: [www.diggaeurope.com](http://www.diggaeurope.com)

## Skid Hoe

<b>TROUBLE</b>	<b>POSSIBLE CAUSE</b>	<b>REMEDY</b>
Insufficient digging depth	Worn teeth on bucket	Replace teeth
		Contact Digga for more information about replacing wearparts
Oil Leaking from cylinder hydraulic fittings	Hydraulic fittings not tight	Tighten hydraulic fittings
Attachment bucket not moving	Couplers not connected to loader	Inspect and connect accordingly

**Notes**



## Warranty Statement

All new Digga products are warranted to be free from defects in materials or workmanship, for a period of twelve (12) months from date of original purchase, which may cause failure under normal usage and service when used for the purpose intended. Digga Australia Pty Ltd warrants its equipment for a period of twelve (12) months dating from delivery to the original user.

In the event of failure (excluding cable, ground engaging parts such as sprockets, digging chain, bearings, teeth, tamping and demolition heads, blade cutting edges, pilot bits, auger teeth, auger heads), if after examination, Digga determines failure was due to defective material and/or workmanship, parts only will be repaired or replaced. Digga may request defective product or products be returned prepaid to them for inspection at their place of business or to a location specified by Digga. The warranty will be considered void if the product or any part of the product is modified or repaired in any way not expressly authorized by Digga, or if closed components are disassembled prior to return. Closed components include, but are not limited to: gearboxes, hydraulic pumps, motors, cylinders and actuators. Any goods returned to Digga by the customer under warranty or repair must have all freight charges prepaid for on the customers account.

Any claims under this warranty must be made within fifteen (15) days after the Buyer learns of the facts upon which such claim is based. All claims not made in writing and received by Digga outside the time period specified above shall be deemed waived.

### **Damage or failure through operator abuse or negligence voids warranty.**

This warranty is in lieu of all other warranties expressed or implied and there are no warranties of merchantability or of fitness for a particular purpose. In no event shall Digga be liable for consequential or special damage. Digga's liability for any and all losses and damages to buyer, resulting from any cause whatsoever, including Digga's negligence, irrespective of whether such defects are discoverable or latent, shall in no event exceed the purchase price of the particular products with respect to which losses or damages are claimed, or, at the election of Digga, the repair or replacement of defective or damaged products.

